



NEWS RELEASE

EL PASO DISTRICT

Jennifer Wright

(915) 790-4340

Jennifer.Wright3@txdot.gov

a TxDOT Project

For immediate release

January 18, 2017

Mesa

Continuous for 6 weeks

The following closures started on Wednesday, Jan. 18, and will continue until 4 p.m. on Friday, Feb. 24

- The right turn-only lane on North Mesa Street (SH 20) will be closed between Osborne Drive and South Desert Boulevard (traveling in the direction toward Remcon).
- The right through lane on North Mesa Street (SH 20) will also be closed between Osborne Drive and South Desert Boulevard (traveling in the direction toward Remcon); however, when possible, crews will open the through lane during rush hours and at night.

Note: The two left lanes on North Mesa Street (SH 20) will remain open and access to businesses will be available at all times.

Crews will be installing underground utilities. [Map 2]

I-10 Both Directions

Overnight

Sunday, Jan. 22 and Monday, Jan. 23

9 p.m. each night to 6 a.m. each morning

- The left lane on I-10 Westbound will be closed between the Sunland Park Overpass and the North Mesa Underpass.
- I-10 Eastbound will be completely closed at the North Mesa Exit Ramp (Exit 11).

Detour: Motorists on I-10 East will exit at North Mesa Street (Exit 11), take Doniphan Drive to Sunland Park Drive, and will be able to re-enter I-10 at Sunland Park Drive. **NOTE: Doniphan Drive does not provide access to I-10 nor to US 85 after Sunland Park Drive. Please keep to the detour route.**

Crews will be setting steel beams into place at the Resler Flyover Ramp. [Map 2]

Overnight

Sunday, Jan. 22 through Sunday, Feb. 6

9 p.m. to 6 a.m.

- I-10 in both directions will be reduced to one lane at the North Mesa intersection overpass between Thorn Avenue and approximately 100 feet east of North Mesa Street (SH 20).

Crews will be installing temporary wire retaining walls. [No map]

page 1 of 2



The Texas Department of Transportation is responsible for maintaining 80,000 miles of road and for supporting aviation, rail, and public transportation across the state. GO 10 is a \$158 million reconstruction of Interstate 10 that spans approximately 6 miles on El Paso's West Side between Executive Center Boulevard and North Mesa Street. GO 10 features the addition of collector-distributor lanes and a new direct connector with Border West Expressway.

Maintain a Safe System • Address Congestion • Best-in-Class State Agency • Connect Texas Communities

An Equal Opportunity Employer

www.go10elpaso.com | facebook.com/go10elpaso | twitter.com/go10ep



a TxDOT Project
For immediate release

NEWS RELEASE

EL PASO DISTRICT

Jennifer Wright
(915) 790-4340
Jennifer.Wright3@txdot.gov

Overnight

Tuesday, Jan. 24 through Thursday, Jan. 26

9 p.m. each night to 6 a.m. each following morning

- I-10 Westbound will be completely closed at the Resler Exit Ramp (Exit 12).
- The left lane on I-10 Eastbound will be closed between the North Mesa Entrance Ramp and just past the Resler Flyover Ramp.

Detour: Motorists on I-10 West will exit at Resler Drive (Exit 12) and take North Mesa Street (SH 20) westward to I-10 where they can re-enter I-10 West.

Crews will be setting steel beams into place at the Resler Flyover Ramp. [Map 1]

I-10 West

Daytime

Monday, Jan. 23 through Friday, Jan. 27

9 a.m. to 4 p.m. each day

- The two-lane Sunland Park Exit Ramp (Exit 13, Westbound) will be reduced to one lane.

Crews will be working on retaining walls. [Map 3]

I-10 East

Continuous for 2 weeks

The following closure started on Wednesday, Jan. 18, and will continue until 4 p.m. on Wednesday, Feb. 1

- Paisano Drive (US 85) eastbound will be closed between Sunland Park Drive and Crockett Street.

Business access: Nearby businesses can be accessed from Sunland Park Drive, Constitution Drive and Crockett Street.

Crews will be working along a portion of Paisano Drive (US 85). [Map 3]

page 2 of 2

Closure start times and end times are approximate.

All closures are subject to change.

Find the latest information on the traffic alerts page at go10elpaso.com or at twitter.com/GO10EP.



The Texas Department of Transportation is responsible for maintaining 80,000 miles of road and for supporting aviation, rail, and public transportation across the state. GO 10 is a \$158 million reconstruction of Interstate 10 that spans approximately 6 miles on El Paso's West Side between Executive Center Boulevard and North Mesa Street. GO 10 features the addition of collector-distributor lanes and a new direct connector with Border West Expressway.

Maintain a Safe System • Address Congestion • Best-in-Class State Agency • Connect Texas Communities

An Equal Opportunity Employer

www.go10elpaso.com | facebook.com/go10elpaso | twitter.com/go10ep

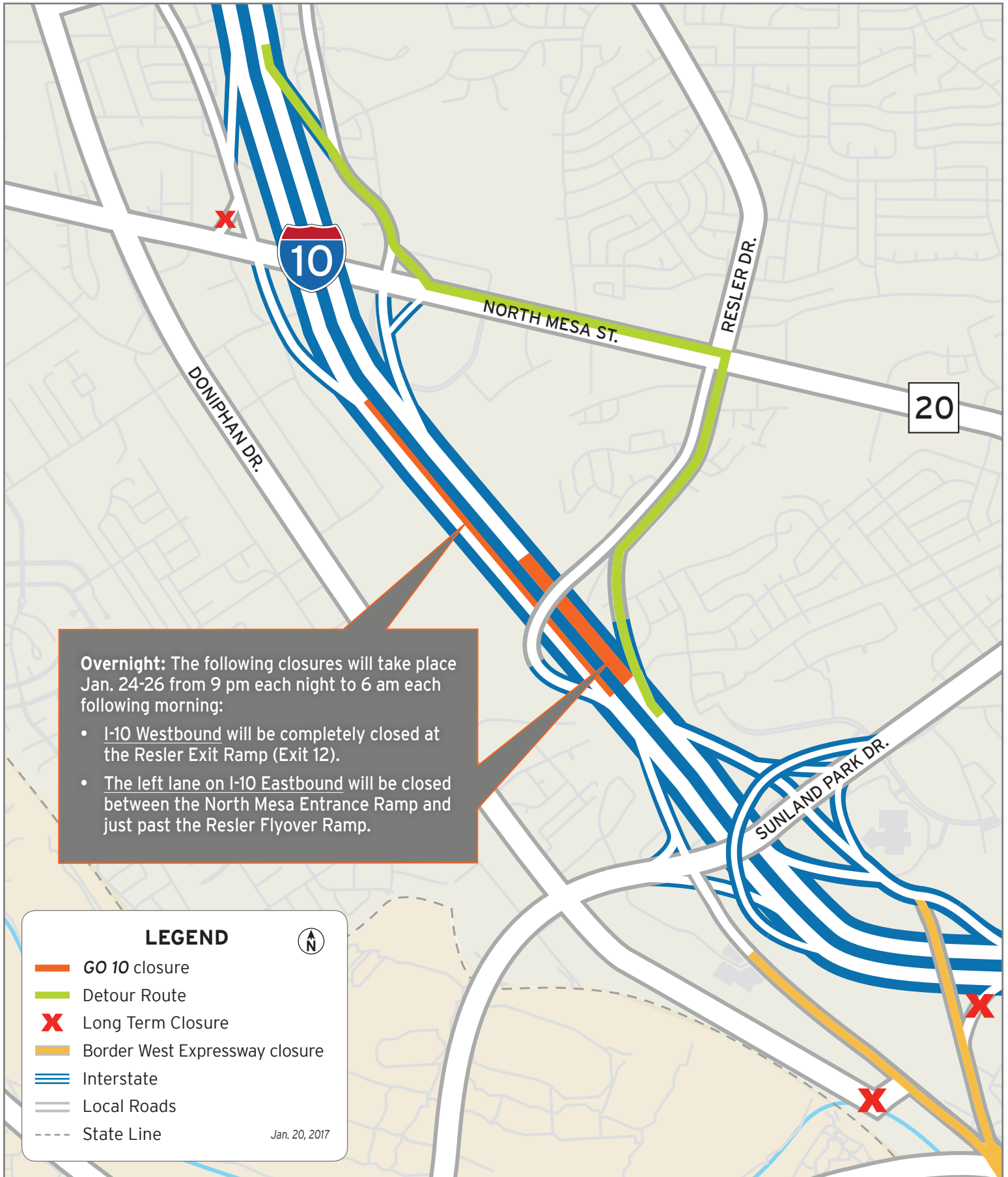

Closures on I-10

Map 1 of 3



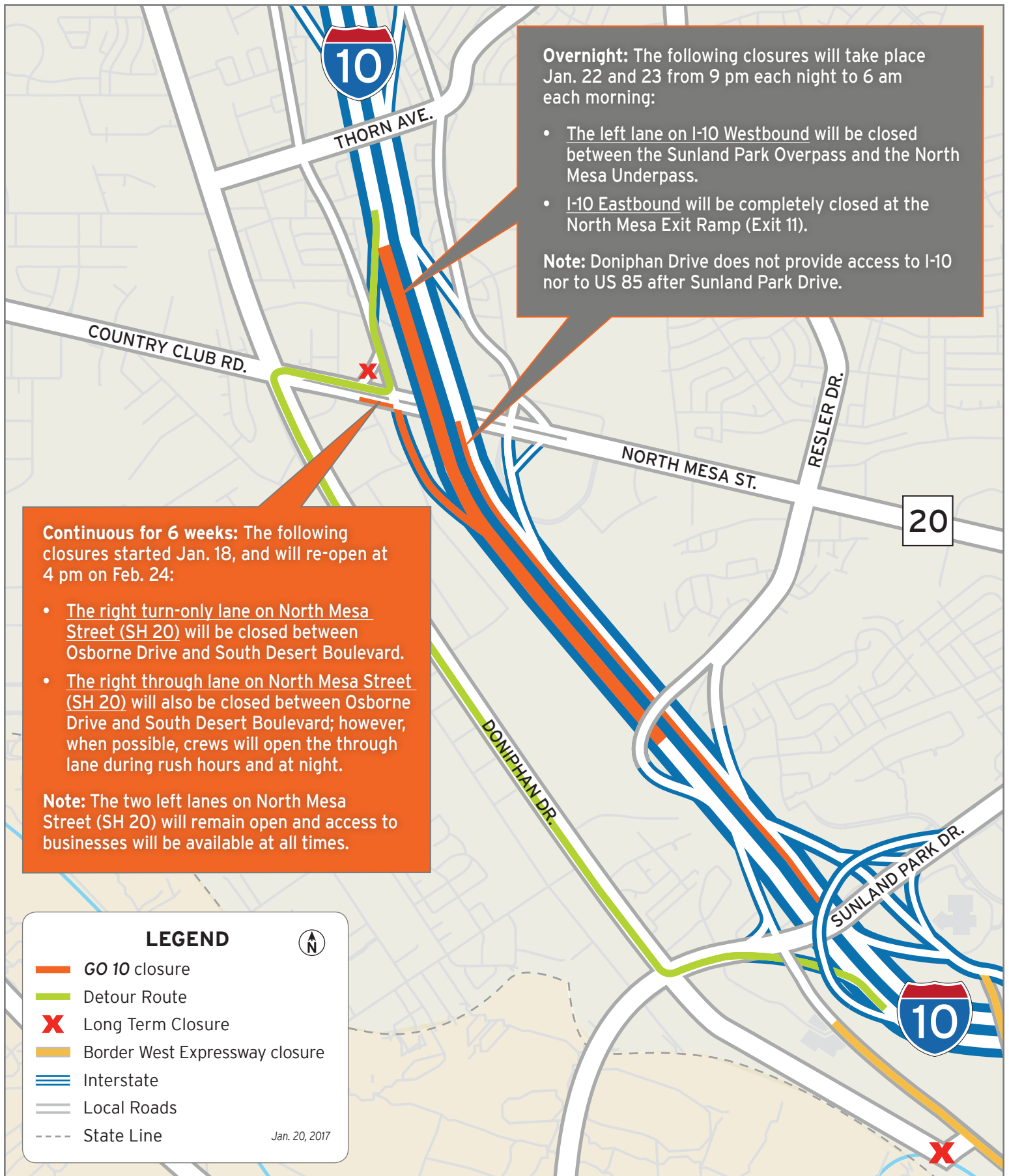

Overnight: The following closures will take place Jan. 22 and 23 from 9 pm each night to 6 am each morning:

- The left lane on I-10 Westbound will be closed between the Sunland Park Overpass and the North Mesa Underpass.
- I-10 Eastbound will be completely closed at the North Mesa Exit Ramp (Exit 11).







Note: Doniphan Drive does not provide access to I-10 nor to US 85 after Sunland Park Drive.

Continuous for 6 weeks: The following closures started Jan. 18, and will re-open at 4 pm on Feb. 24:

- The right turn-only lane on North Mesa Street (SH 20) will be closed between Osborne Drive and South Desert Boulevard.
- The right through lane on North Mesa Street (SH 20) will also be closed between Osborne Drive and South Desert Boulevard; however, when possible, crews will open the through lane during rush hours and at night.

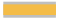
Note: The two left lanes on North Mesa Street (SH 20) will remain open and access to businesses will be available at all times.

LEGEND 

-  GO 10 closure
-  Detour Route
-  Long Term Closure
-  Border West Expressway closure
-  Interstate
-  Local Roads
-  State Line

Jan. 20, 2017



Closures on I-10 and Mesa

Map 2 of 3



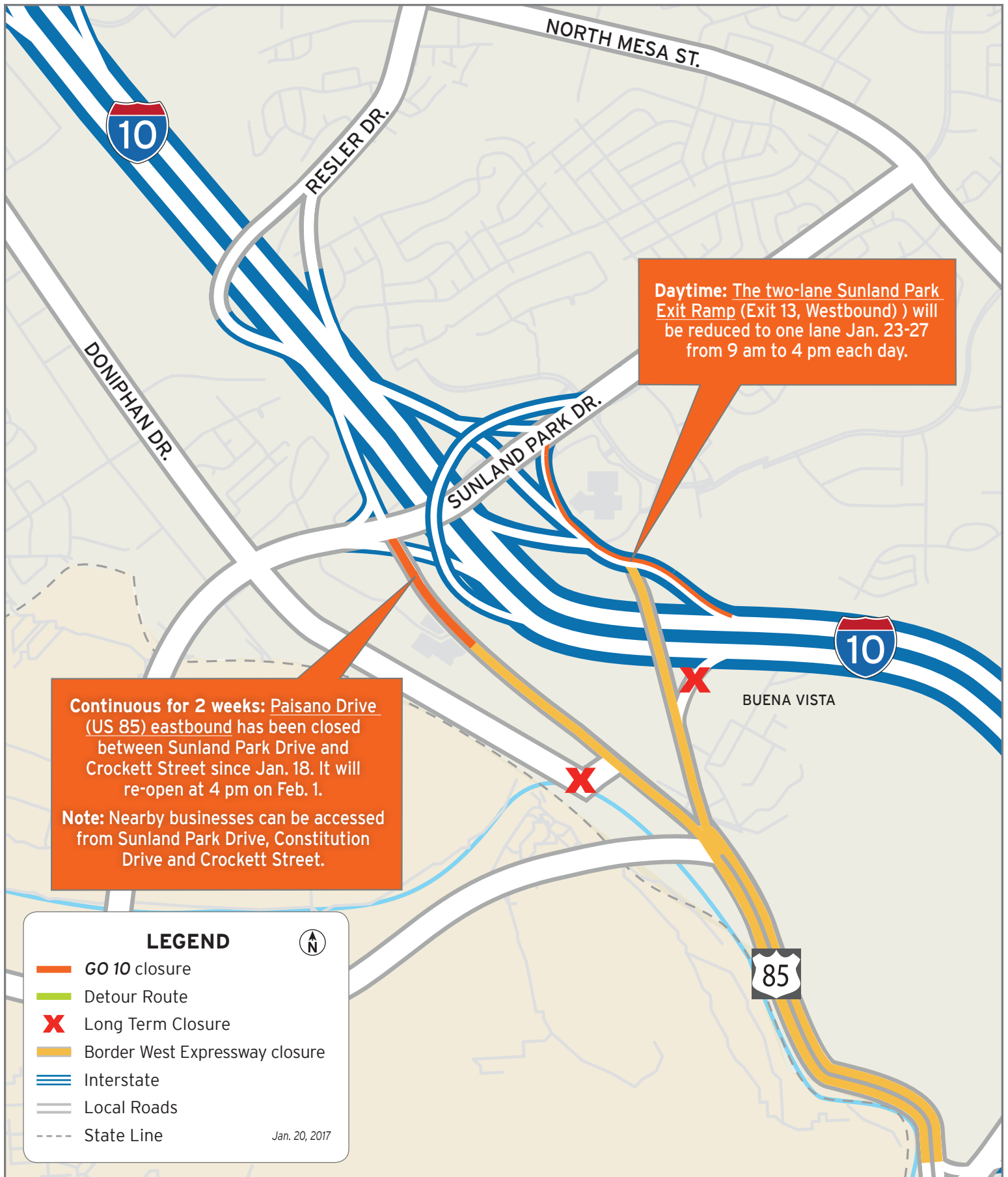

Multiple day closures near Sunland

Map 3 of 3

