



a TxDOT Project
For immediate release

NEWS RELEASE

EL PASO DISTRICT

Blanca Del Valle
(915) 790-4341
Blanca.DelValle@txdot.gov

June 23, 2016

Mesa

Daytime

The right lane on North Mesa Street (SH 20), between Osborne Drive and South Desert Boulevard in the direction headed toward North Desert Boulevard (in front of Village Inn), will be closed from 9 a.m. to noon on Monday, **June 27**. Crews will be potholing for a gas line.

I-10 East

Daytime

The eastbound Executive Exit Ramp (Exit 16) will be closed from 9 a.m. to 1 p.m. on Wednesday, **June 29**. Crews will be pouring concrete for a drainage culvert.

I-10 West

Nighttime

I-10 West will be closed between the Buena Vista Bridge (aka the Bridge to Nowhere) and the Sunland Park Overpass for 11 nights — from July 5-19 each night (Sun-Thurs) from 9 p.m. to 5 a.m. as follows:

- > 9 p.m. Tuesday, **July 5** to 5 a.m. the following morning
- > 9 p.m. Wednesday, **July 6** to 5 a.m. the following morning
- > 9 p.m. Thursday, **July 7** to 5 a.m. the following morning
- > 9 p.m. Sunday, **July 10** to 5 a.m. the following morning
- > 9 p.m. Monday, **July 11** to 5 a.m. the following morning
- > 9 p.m. Tuesday, **July 12** to 5 a.m. the following morning
- > 9 p.m. Wednesday, **July 13** to 5 a.m. the following morning
- > 9 p.m. Thursday, **July 14** to 5 a.m. the following morning
- > 9 p.m. Sunday, **July 17** to 5 a.m. the following morning
- > 9 p.m. Monday, **July 18** to 5 a.m. the following morning
- > 9 p.m. Tuesday, **July 19** to 5 a.m. the following morning

This closure is necessary while crews hang steel girders for what will become the new I-10 westbound direct connector ramp from Paisano Drive (US 85). Read more about **GO 10's** construction activities in the I-10/US 85 area at <http://bit.ly/TimSays2>.

###



The Texas Department of Transportation is responsible for maintaining 80,000 miles of road and for supporting aviation, rail, and public transportation across the state. GO 10 is a \$158 million reconstruction of Interstate 10 that spans approximately 6 miles on El Paso's West Side between Executive Center Boulevard and North Mesa Street. GO 10 features the addition of collector-distributor lanes and a new direct connector with Border West Expressway.

Maintain a Safe System • Address Congestion • Best-in-Class State Agency • Connect Texas Communities

An Equal Opportunity Employer

www.go10elpaso.com | facebook.com/go10elpaso | twitter.com/go10ep

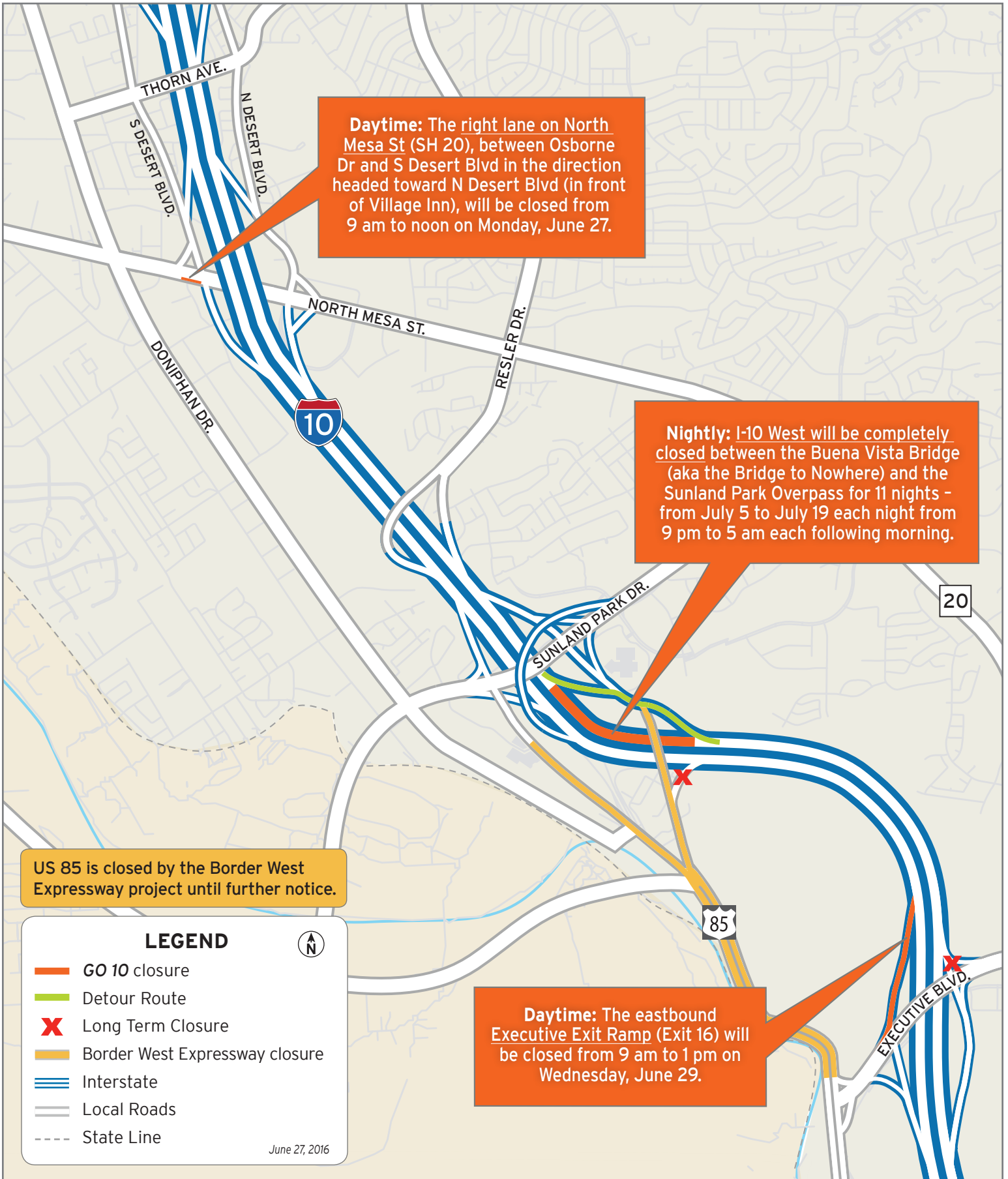

Various closures along the corridor scheduled

