



**a TxDOT Project**  
For immediate release

## NEWS RELEASE

### EL PASO DISTRICT

Blanca Del Valle  
(915) 790-4341  
Blanca.DelValle@txdot.gov

June 23, 2016

### Inside lane on I-10 East to close Friday

#### I-10 East

##### Daytime:

The left lane on I-10 East, between the Buena Vista Overpass and the Executive Overpass, will be closed from 9 a.m. to 4 p.m. on Friday, **June 24**. Crews will be enhancing a worn section of the shoulder.

###



The Texas Department of Transportation is responsible for maintaining 80,000 miles of road and for supporting aviation, rail, and public transportation across the state. GO 10 is a \$158 million reconstruction of Interstate 10 that spans approximately 6 miles on El Paso's West Side between Executive Center Boulevard and North Mesa Street. GO 10 features the addition of collector-distributor lanes and a new direct connector with Border West Expressway.

Maintain a Safe System • Address Congestion • Best-in-Class State Agency • Connect Texas Communities

An Equal Opportunity Employer



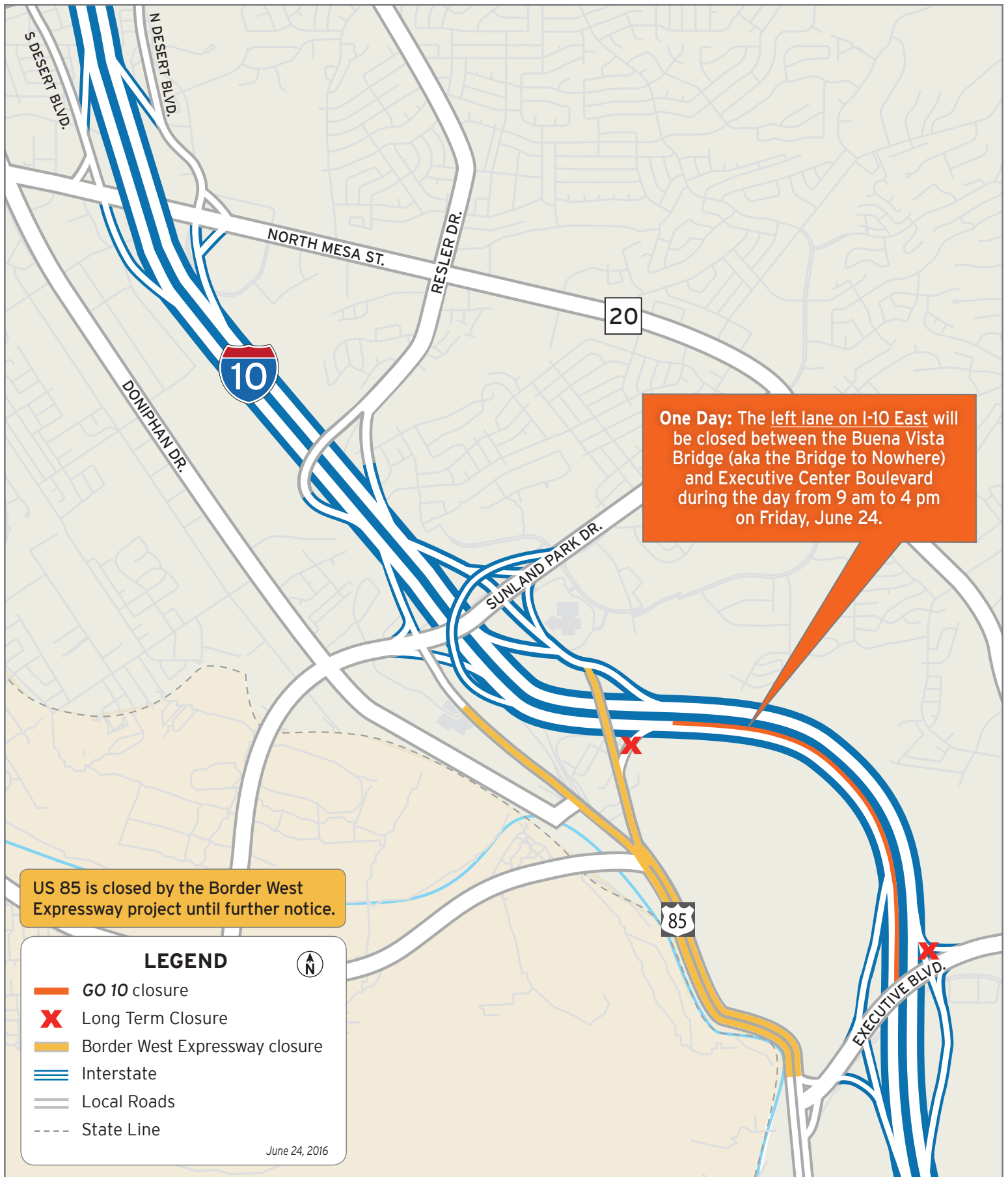



[www.go10elpaso.com](http://www.go10elpaso.com) | [facebook.com/go10elpaso](https://facebook.com/go10elpaso) | [twitter.com/go10ep](https://twitter.com/go10ep)



**One Day:** The left lane on I-10 East will be closed between the Buena Vista Bridge (aka the Bridge to Nowhere) and Executive Center Boulevard during the day from 9 am to 4 pm on Friday, June 24.

US 85 is closed by the Border West Expressway project until further notice.

**LEGEND** 

-  GO 10 closure
-  Long Term Closure
-  Border West Expressway closure
-  Interstate
-  Local Roads
-  State Line

June 24, 2016



# Lane closure on I-10 East from Buena Vista to Executive

