



**a TxDOT Project**  
For immediate release

## NEWS RELEASE

### EL PASO DISTRICT

Jennifer Wright  
(915) 790-4340  
Jennifer.Wright3@txdot.gov

February 3, 2017

## Last week's closures will recur this week. One new closure added.

### I-10 @ Mesa

#### Continuous for 6 weeks

The following closures started on Jan. 18 and will continue until 4 p.m. on Friday, Feb. 24:

- The right turn-only lane on eastbound North Mesa Street (SH 20) will close between Osborne Drive and South Desert Boulevard.
- The right through lane on eastbound North Mesa Street (SH 20) will close between Osborne Drive and South Desert Blvd, but only when necessary and only during the day from 9 a.m. to 4 p.m.

Note: Two lanes will remain open on N. Mesa (SH 20) and business access will be open at all times. Crews will be installing underground utilities. [Map 2]

#### Overnight

Monday, Feb. 6 through Thursday, Feb. 9

9 p.m. each night to 6 a.m. each morning

- I-10 in both directions will reduce to one lane at the North Mesa intersection overpass between Thorn Avenue and approximately 100 feet east of North Mesa Street (SH 20).

Crews will be moving dirt. [No Map]

#### Overnight

Monday, Feb. 6 through Thursday, Feb. 9

9 p.m. each night to 6 a.m. each morning

- I-10 Eastbound will completely close at the North Mesa Exit Ramp (Exit 11).
- North Mesa Street (SH 20) at the I-10 Overpass will close in both directions.

Detour: Motorists on I-10 East will exit at North Mesa Street (Exit 11), take Doniphan Drive to Sunland Park Drive, and will be able to re-enter I-10 from Sunland Park Drive.

**NOTE: Keep to the detour route.** Doniphan Drive does not provide access to I-10 nor to US 85 after Sunland Park Drive.

This closure will be recurring until further notice. Crews are placing bridge deck onto I-10 directly over N. Mesa St. (SH 20). [Map 2]

page 1 of 3



The Texas Department of Transportation is responsible for maintaining 80,000 miles of road and for supporting aviation, rail, and public transportation across the state. GO 10 is a \$158 million reconstruction of Interstate 10 that spans approximately 6 miles on El Paso's West Side between Executive Center Boulevard and North Mesa Street. GO 10 features the addition of collector-distributor lanes and a new direct connector with Border West Expressway.

Maintain a Safe System • Address Congestion • Best-in-Class State Agency • Connect Texas Communities

An Equal Opportunity Employer

[www.go10elpaso.com](http://www.go10elpaso.com) | [facebook.com/go10elpaso](https://facebook.com/go10elpaso) | [twitter.com/go10ep](https://twitter.com/go10ep)



**a TxDOT Project**  
For immediate release

# NEWS RELEASE

## EL PASO DISTRICT

Jennifer Wright  
(915) 790-4340  
Jennifer.Wright3@txdot.gov

### I-10 @ Resler

#### Overnight

Monday, Feb. 6 through Thursday, Feb. 9  
9 p.m. each night to 6 a.m. each morning

- The Resler Flyover Ramp to I-10 Eastbound will close.

Crews will be working on the existing Resler ramp structure. [No Map]

#### Overnight

Wednesday, Feb. 8 and Thursday, Feb. 9  
9 p.m. each night to 6 a.m. each morning

- I-10 Westbound will completely close after the Resler Exit Ramp (Exit 12).

Detour: Motorists on I-10 West will exit at Resler Drive (Exit 12) and take North Mesa Street (SH 20) westward to I-10 where they can re-enter I-10 West.

This closure will be recurring until further notice. Crews are working on the new Resler ramp. [Map 1]

### Sunland



#### NEW - Overnight

Monday, Feb. 6 through Thursday, Feb. 9  
9 p.m. each night to 6 a.m. each morning

- The Sunland Park Exit Ramp (Exit 13, westbound) will close.

Crews will be working on the Sunland Park ramp structure. [Map 3]

#### Daytime

Monday, Feb. 6 through Friday, Feb. 10  
9 a.m. to 4 p.m. each day

- One lane on the two-lane Sunland Park Exit Ramp (Exit 13, Westbound) will close.

The closure is required to give crews access to the work site. [No Map]

page 2 of 3

Closure start times and end times are approximate.

All closures are subject to change.



The Texas Department of Transportation is responsible for maintaining 80,000 miles of road and for supporting aviation, rail, and public transportation across the state. GO 10 is a \$158 million reconstruction of Interstate 10 that spans approximately 6 miles on El Paso's West Side between Executive Center Boulevard and North Mesa Street. GO 10 features the addition of collector-distributor lanes and a new direct connector with Border West Expressway.

Maintain a Safe System • Address Congestion • Best-in-Class State Agency • Connect Texas Communities

An Equal Opportunity Employer

[www.go10elpaso.com](http://www.go10elpaso.com) | [facebook.com/go10elpaso](https://facebook.com/go10elpaso) | [twitter.com/go10ep](https://twitter.com/go10ep)



**a TxDOT Project**  
For immediate release

## NEWS RELEASE

### EL PASO DISTRICT

Jennifer Wright  
(915) 790-4340  
Jennifer.Wright3@txdot.gov

Find the latest traffic alert information at [go10elpaso.com](http://go10elpaso.com) or [twitter.com/GO10EP](https://twitter.com/GO10EP).

page 3 of 3



The Texas Department of Transportation is responsible for maintaining 80,000 miles of road and for supporting aviation, rail, and public transportation across the state. GO 10 is a \$158 million reconstruction of Interstate 10 that spans approximately 6 miles on El Paso's West Side between Executive Center Boulevard and North Mesa Street. GO 10 features the addition of collector-distributor lanes and a new direct connector with Border West Expressway.

Maintain a Safe System • Address Congestion • Best-in-Class State Agency • Connect Texas Communities

*An Equal Opportunity Employer*

[www.go10elpaso.com](http://www.go10elpaso.com) | [facebook.com/go10elpaso](https://facebook.com/go10elpaso) | [twitter.com/go10ep](https://twitter.com/go10ep)



# Closures on I-10 at Resler

Map 1 of 3



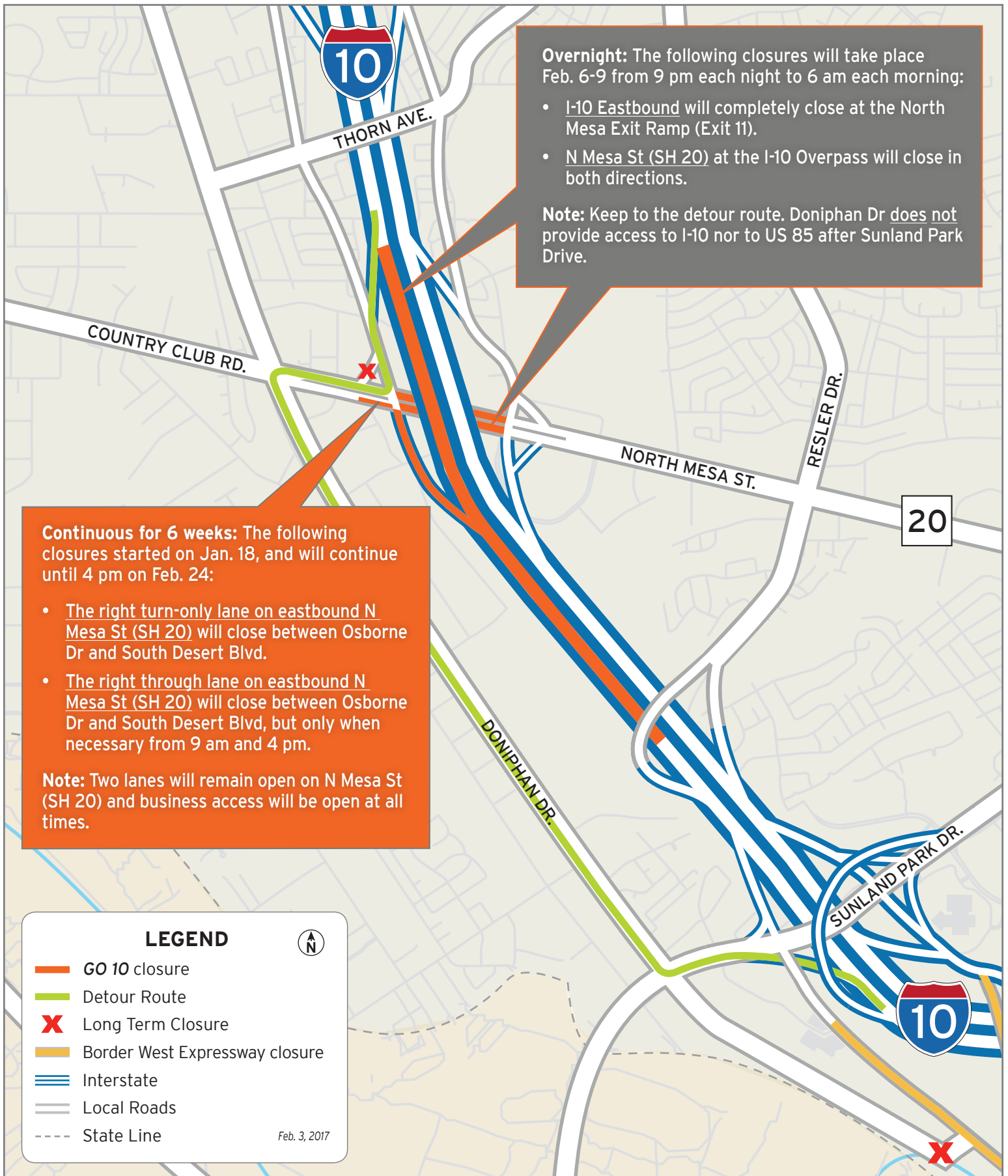

# Closures on I-10 and Mesa

Map 2 of 3



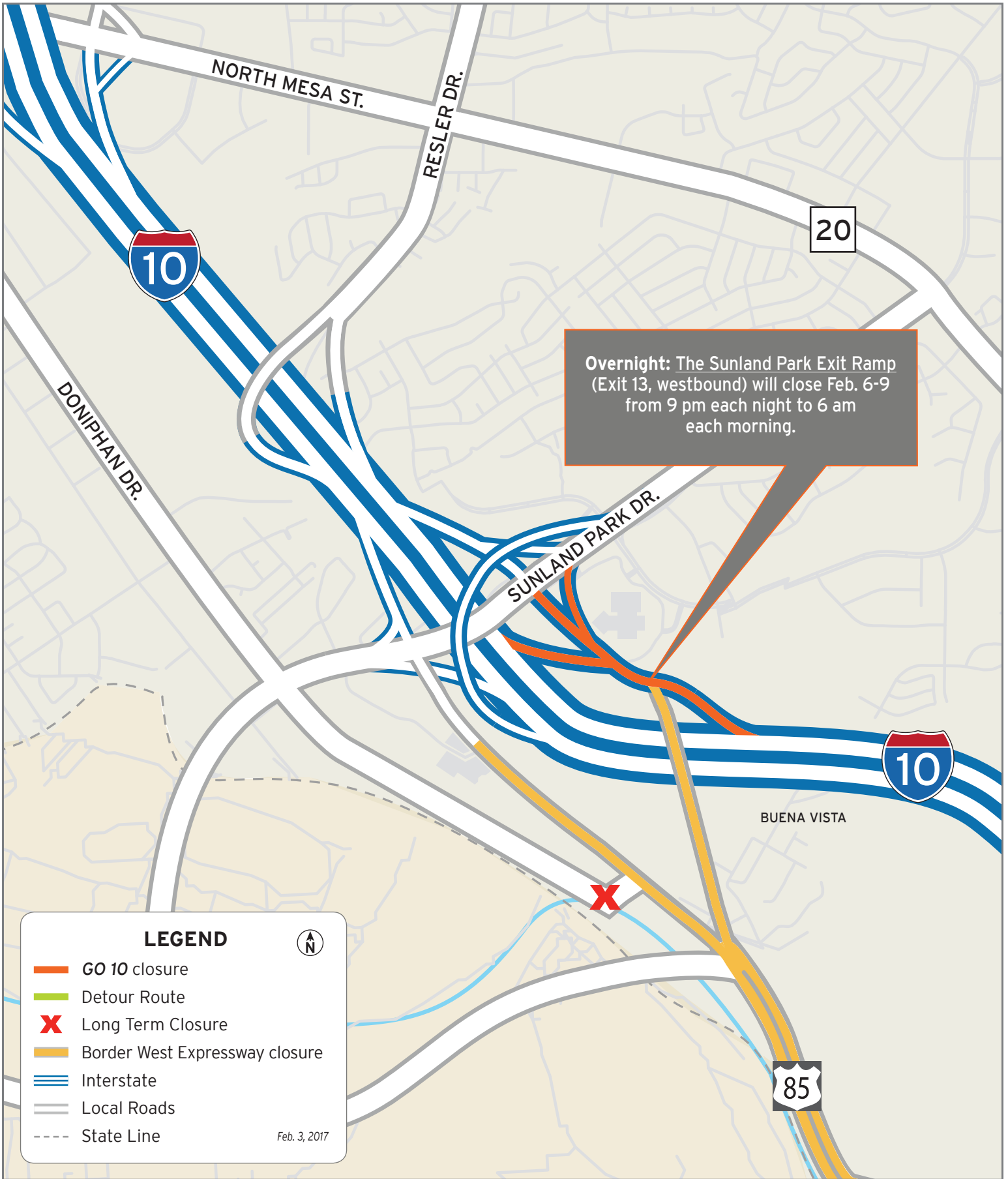

# Sunland Park Exit Ramp will close

Map 3 of 3

