



**a TxDOT Project**  
For immediate release

## NEWS RELEASE

### EL PASO DISTRICT

Jennifer Wright  
(915) 790-4340  
Jennifer.Wright3@txdot.gov

September 2, 2016

#### I-10 EAST

##### Overnight

The following closures will take place over two nights on **Thursday, Sept. 8 and Sunday, Sept. 11** starting at 9 p.m. on both nights and re-opening at 5 a.m. each morning:

- I-10 Eastbound will be reduced to one lane between the Sunland Park Overpass and Buena Vista.
- Sunland Park Flyover Entrance Ramp to I-10 Eastbound will be closed.

This closure is necessary so crews can continue working on the new Paisano (US 85) Bridge. [Map 1]

#### SUNLAND

##### Daytime

One lane in each direction on the Sunland Park Drive Bridge over I-10 will be closed **Tuesday, Sept. 6** from 9 a.m. to 4 p.m. Crews will be surveying the underside of the Sunland Park Flyover Ramp [Map 2]

#### I-10 WEST

##### Overnight

I-10 Westbound will be reduced to one lane between the Executive Center Overpass and the Sunland Park Overpass **Tuesday, Sept. 6 through Thursday, Sept. 8** from 9 p.m. each night to 5 a.m. each morning. This closure is necessary so crews can continue work on the new Paisano (US 85) Bridge and continue paving new westbound lanes. [Map 1]

#### MESA

##### Daytime

A right lane on North Mesa Street (SH 20) will be closed to traffic traveling from Osborne Drive to the westbound North Mesa Exit Ramp **Tuesday, Sept. 6** from 9 a.m. to 4 p.m. Crews will be constructing new columns for the improved I-10 bridge over North Mesa Street. [Map 2]

###



The Texas Department of Transportation is responsible for maintaining 80,000 miles of road and for supporting aviation, rail, and public transportation across the state. GO 10 is a \$158 million reconstruction of Interstate 10 that spans approximately 6 miles on El Paso's West Side between Executive Center Boulevard and North Mesa Street. GO 10 features the addition of collector-distributor lanes and a new direct connector with Border West Expressway.

Maintain a Safe System • Address Congestion • Best-in-Class State Agency • Connect Texas Communities

An Equal Opportunity Employer

[www.go10elpaso.com](http://www.go10elpaso.com) | [facebook.com/go10elpaso](https://facebook.com/go10elpaso) | [twitter.com/go10ep](https://twitter.com/go10ep)

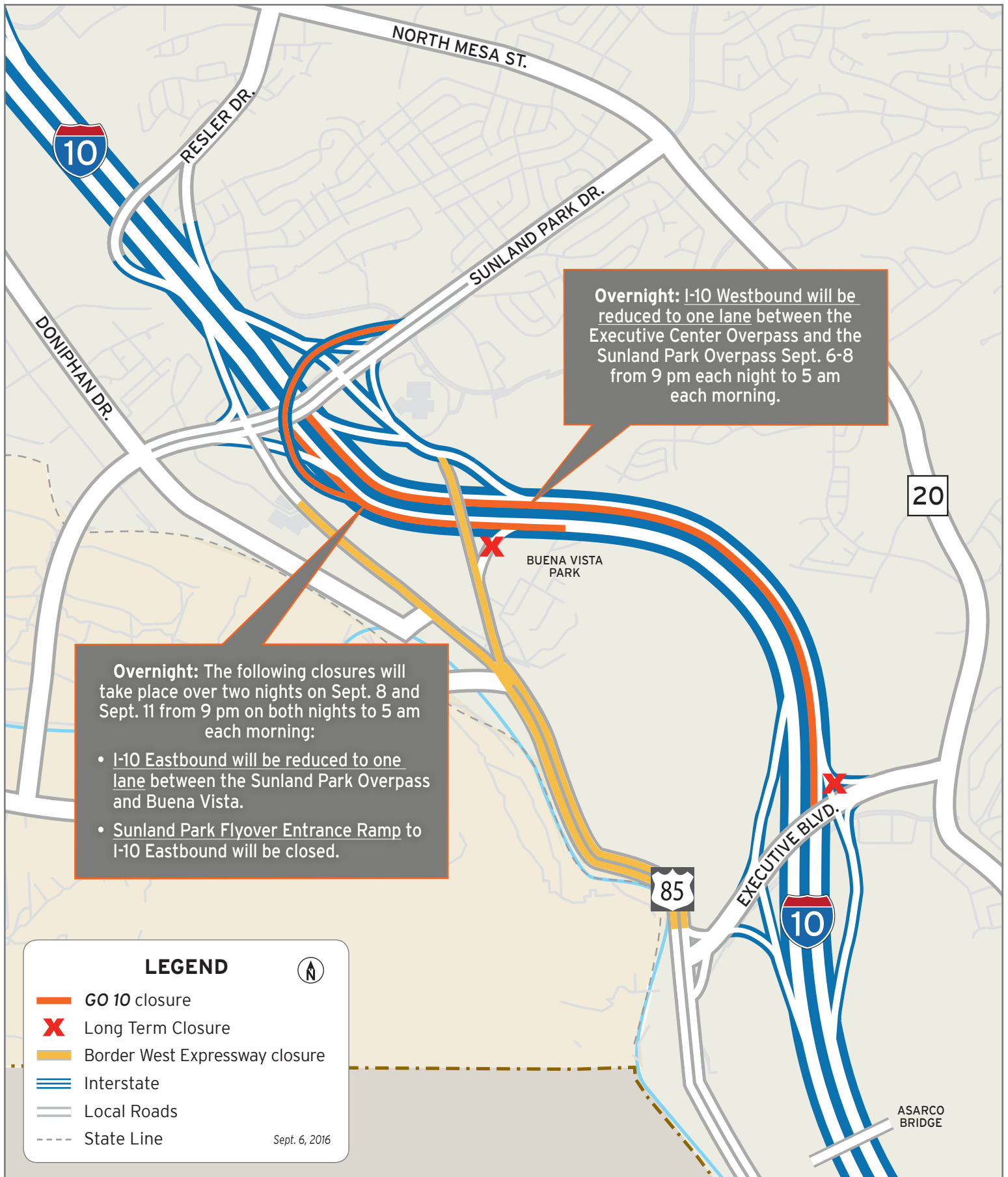

# Closures on I-10

Map 1 of 2



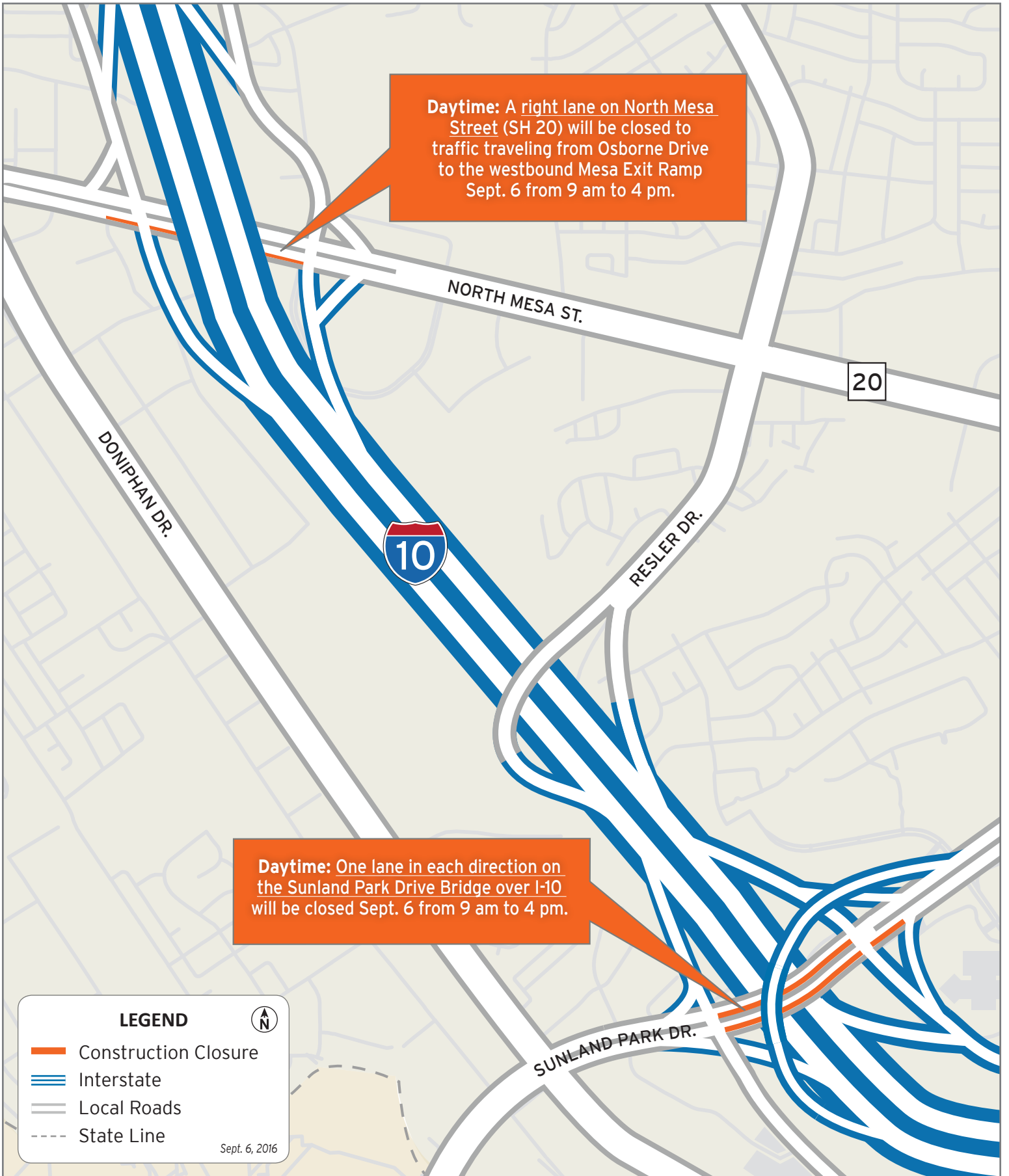

# Closures on Sunland Park Drive and North Mesa Street

Map 2 of 2

