



a TxDOT Project
For immediate release

NEWS RELEASE

EL PASO DISTRICT

Jennifer Wright
(915) 790-4340
Jennifer.Wright3@txdot.gov

March 31, 2017

**This Sunday, I-10 East traffic lanes will switch onto new lanes.
The switch will stay in place for several months.
An entrance ramp from Sunland Park Drive to I-10 East will close permanently.**

14-hour operation @ Sunland



Sunday, April 2

3 a.m. to noon

- I-10 Eastbound will close completely at Sunland Park Dr (Exit 13). Motorists will exit at Sunland Park Dr (Exit 13) and take North Mesa St (SH 20) to Executive Center Blvd. People may re-enter I-10 East from Executive Center Blvd. Follow the detour signs in place.
- The Sunland Park Flyover Entrance Ramp to I-10 Eastbound will close.
- The Resler Flyover Entrance Ramp to I-10 Eastbound will close.
- Paisano Drive (US 85) will close at Sunland Park Dr and at Crockett St.

The above closures are necessary while crews re-stripe the lanes of I-10 East, which will result in traffic being shifted to the right and onto the brand-new CD lanes (collector-distributor lanes). This closure will stay in place for several months. [Map 1]

Noon to 5 p.m.

- Only one lane on I-10 Eastbound will be open between Sunland Park Dr and Executive Center Blvd. Crews will be moving barrier walls during this period as part of the traffic switch operation. [Map 2]

3 a.m., permanently

- The Sunland Park Underpass Entrance Ramp to I-10 Eastbound (the ramp from the Doniphan side of I-10) will close permanently.

By noon on April 2, motorists will be able to enter I-10 East from Sunland Park Drive by turning right at the Sunland/Paisano traffic light. The permanent closure of the underpass ramp is necessary as crews begin the process of transforming the entire I-10/Sunland Interchange. [Map 1 and 2]

Drivers are urged to be alert and use caution. The I-10/Sunland Interchange is one of the most complex sections of the **GO 10** project. Crews are already several months into the early stages of construction. The interchange is scheduled for completion in 2019. A rendering of the completed interchange is on the next page.

page 1 of 3



The Texas Department of Transportation is responsible for maintaining 80,000 miles of road and for supporting aviation, rail, and public transportation across the state. GO 10 is a \$158 million reconstruction of Interstate 10 that spans approximately 6 miles on El Paso's West Side between Executive Center Boulevard and North Mesa Street. GO 10 features the addition of collector-distributor lanes and a new direct connector with Border West Expressway.

Maintain a Safe System • Address Congestion • Best-in-Class State Agency • Connect Texas Communities

An Equal Opportunity Employer

www.go10elpaso.com | facebook.com/go10elpaso | twitter.com/go10ep



NEWS RELEASE

EL PASO DISTRICT

Jennifer Wright

(915) 790-4340

Jennifer.Wright3@txdot.gov

a TxDOT Project

For immediate release



Pictured: The darker pavement represents the currently existing I-10 lanes. The lighter-colored pavement represents the yet-to-come, new portions of the interchange. Both the Sunland Park Drive overpass and the flyover bridge will be new and improved.

OTHER CLOSURES FOR NEXT WEEK

I-10 & Sunland

Overnight

Sunday, April 2 through Thursday, April 6

9 p.m. each night to 6 a.m. each morning

- The Sunland Park Flyover Entrance Ramp to I-10 Eastbound will close.
- Sunland Park Drive in both directions will reduce to one lane between Mesa Hills Dr and Constitution Dr.

Crews are conducting prep work for the eventual removal of the Sunland Flyover Ramp. [Map 3]

page 2 of 3



The Texas Department of Transportation is responsible for maintaining 80,000 miles of road and for supporting aviation, rail, and public transportation across the state. GO 10 is a \$158 million reconstruction of Interstate 10 that spans approximately 6 miles on El Paso's West Side between Executive Center Boulevard and North Mesa Street. GO 10 features the addition of collector-distributor lanes and a new direct connector with Border West Expressway.

Maintain a Safe System • Address Congestion • Best-in-Class State Agency • Connect Texas Communities

An Equal Opportunity Employer

www.go10elpaso.com | facebook.com/go10elpaso | twitter.com/go10ep



a TxDOT Project
For immediate release

NEWS RELEASE

EL PASO DISTRICT

Jennifer Wright
(915) 790-4340
Jennifer.Wright3@txdot.gov

Daytime

Monday, April 3 through Friday, April 7

9 a.m. to 4 p.m. each day

- The two-lane Sunland Exit Ramp (Exit 13, Westbound) will reduce to one lane.

This closure is necessary to give crews access to the work site. [No Map]

Daytime

Monday, April 3 through Friday, April 7

9 a.m. to 4 p.m. each day

- The left lane on I-10 in both directions will close between Buena Vista and Sunland Park.

Crews are constructing new concrete columns in the area. [Map 3]

Overnight

Tuesday, April 4 and Wednesday, April 5

9 p.m. each night to 6 a.m. each morning

- I-10 Eastbound will reduce to one lane between Resler and Buena Vista.

Crews are conducting structural work. [No Map]

Overnight

Thursday, April 6

9 p.m. to 6 a.m. the following morning

- I-10 Westbound will reduce to one lane between Buena Vista and Resler.

Crews are conducting structural work. [No Map]

I-10 & Executive

Daytime

Monday, April 3

9 a.m. to 4 p.m.

- The Executive Center Exit Ramp (Exit 16) from I-10 Westbound will be open; however, the right-turn-only lane from the exit ramp onto Executive Center Blvd will close. Motorists may turn right at the traffic light.

Crews are working on a service pole. [Map 3]

All closure start times and end times are approximate. All closures are subject to change.

The latest information may be found on the traffic alerts page at go10elpaso.com.

page 3 of 3



The Texas Department of Transportation is responsible for maintaining 80,000 miles of road and for supporting aviation, rail, and public transportation across the state. GO 10 is a \$158 million reconstruction of Interstate 10 that spans approximately 6 miles on El Paso's West Side between Executive Center Boulevard and North Mesa Street. GO 10 features the addition of collector-distributor lanes and a new direct connector with Border West Expressway.

Maintain a Safe System • Address Congestion • Best-in-Class State Agency • Connect Texas Communities

An Equal Opportunity Employer

www.go10elpaso.com | facebook.com/go10elpaso | twitter.com/go10ep

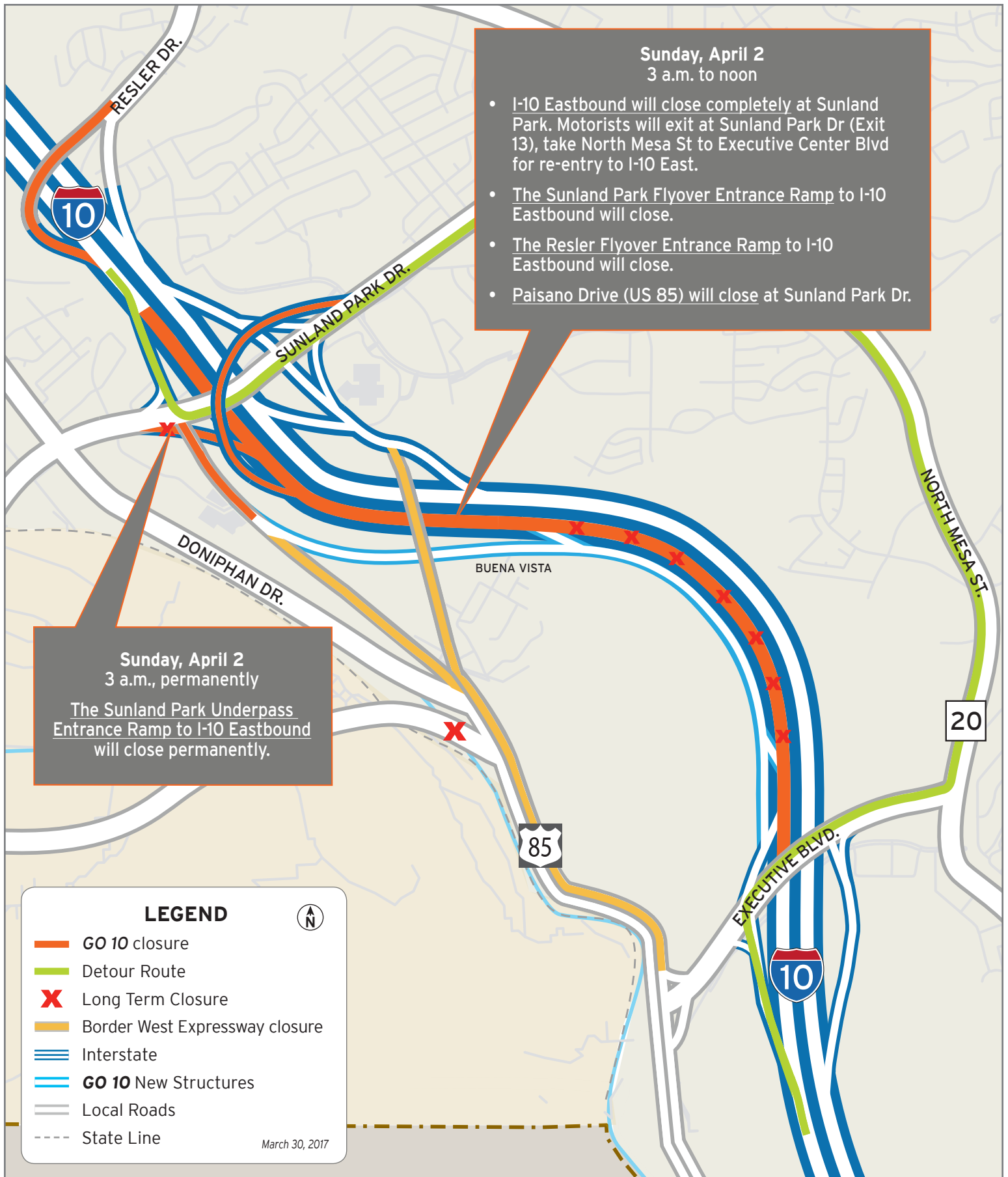

Closures on I-10 East at Sunland

Map 1 of 3



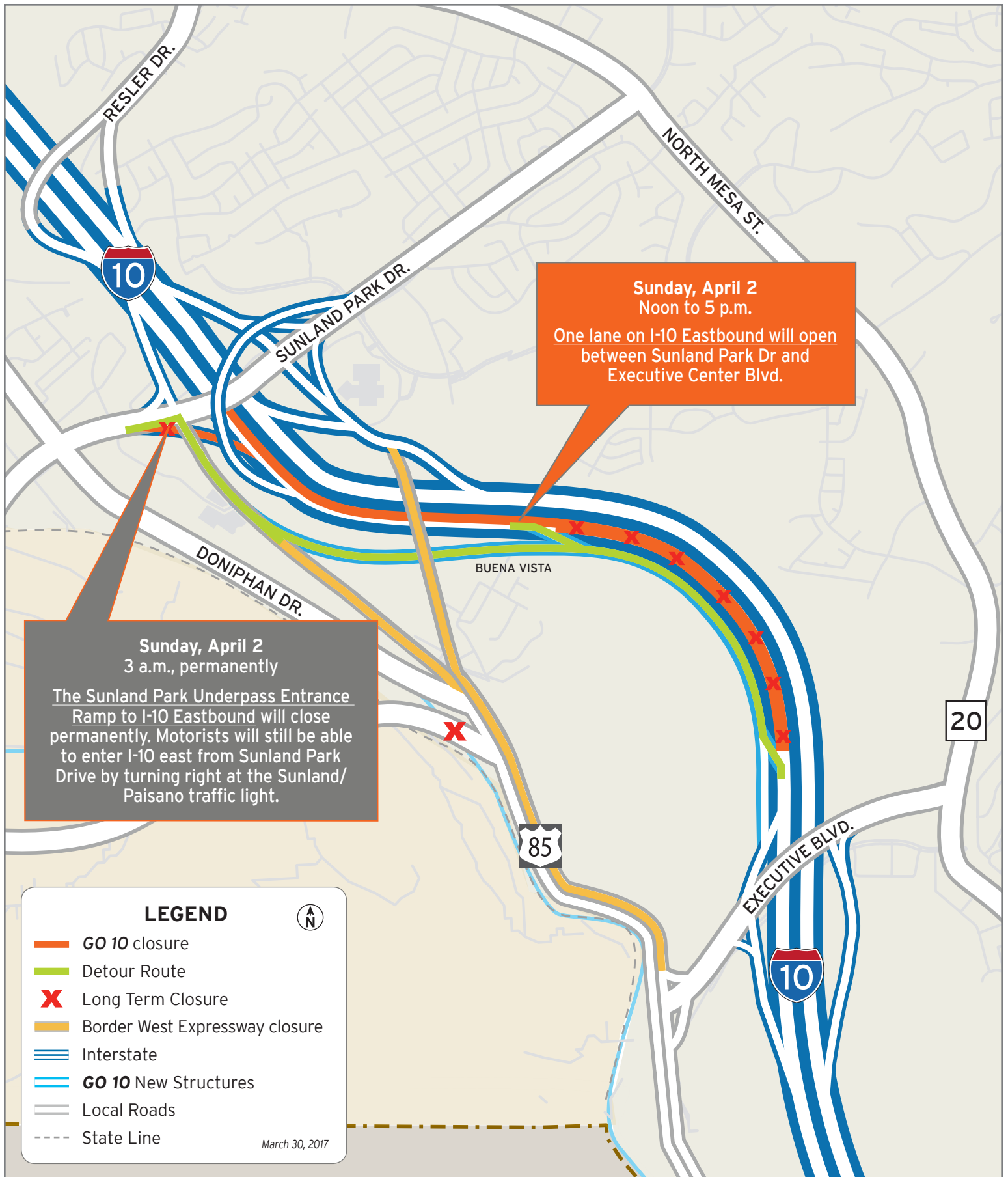

Traffic switch on I-10 East is long-term

Map 2 of 3



Overnight: The following closures will take place April 2-6 from 9 pm each night to 6 am each morning:

- The Sunland Park Flyover Entrance Ramp to I-10 Eastbound will close.
- Sunland Park Drive in both directions will reduce to one lane between Mesa Hills Dr and Constitution Dr.

Daytime: The Executive Center Exit Ramp (Exit 16) from I-10 Westbound will be open; however, the right-turn-only lane onto Executive Center Blvd will close April 3 from 9 am to 4 pm. Motorists may turn right at the traffic light.

Daytime: The left lane on I-10 in both directions will close between Buena Vista and Sunland Park April 5-7 from 9 am to 4 pm each day.

LEGEND

- GO 10 closure
- Detour Route
- Long Term Closure
- Border West Expressway closure
- Interstate
- GO 10 New Structures
- Local Roads
- State Line

March 30, 2017

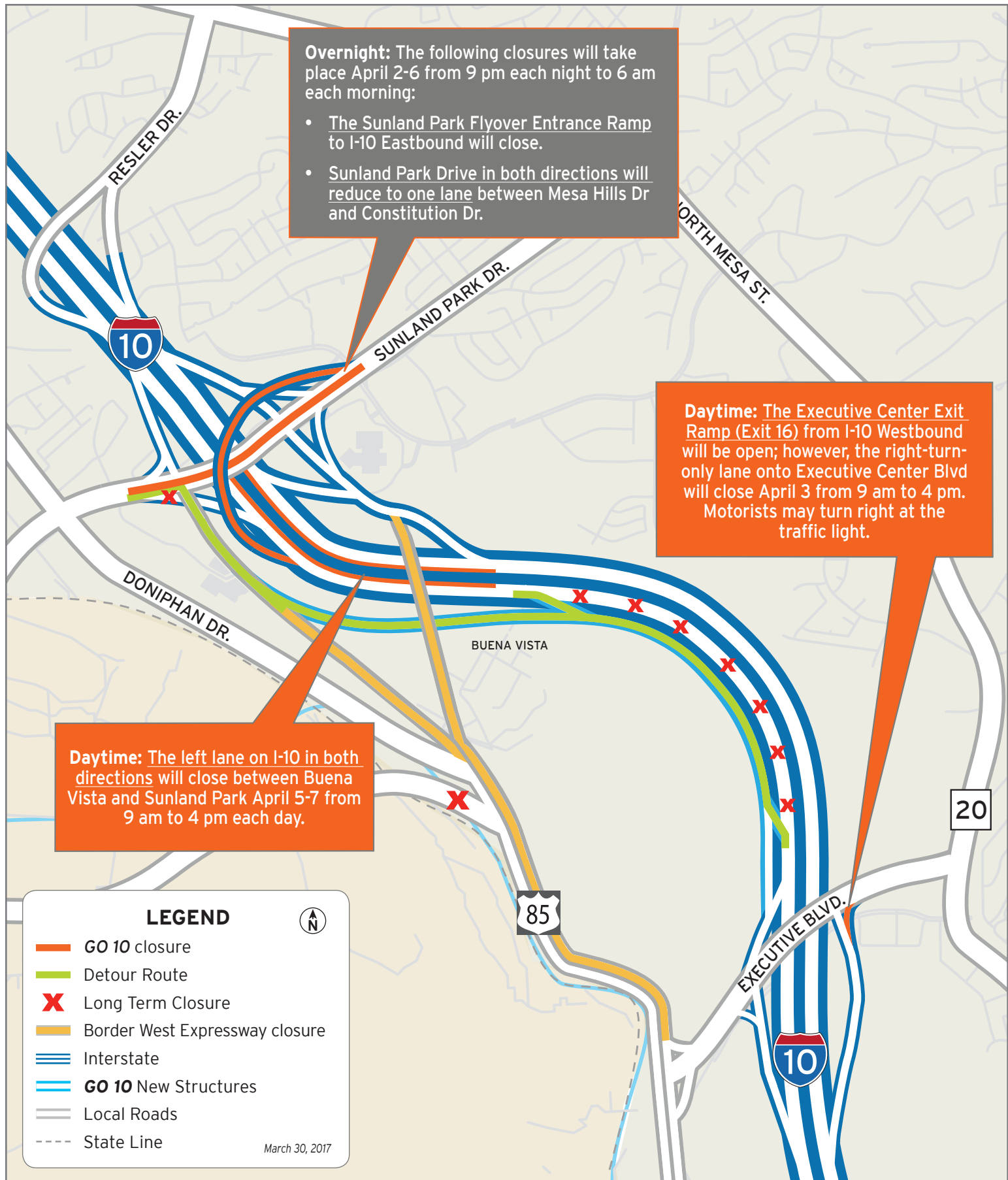

Closures on I-10, Sunland and Executive

Map 3 of 3

