



a TxDOT Project
For immediate release

NEWS RELEASE

EL PASO DISTRICT

Jennifer Wright
(915) 790-4340
Jennifer.Wright3@txdot.gov

June 5, 2019

Roads are in their final design and open to traffic.

For the next couple of months, crews will continue working to finish last remaining checklist items. Road closures will be necessary during this time to keep workers and drivers safe.

Sunland Park

Overnight

Monday, July 8

9 p.m. to 6 a.m.

- Sunland Park Drive – in the direction traveling northbound, toward the mountain – will close completely at the I-10 overpass. Detour: Motorists who wish to travel northbound on the Sunland Park Drive and across the overpass should follow the detour signs in place.
- Eastbound Paisano Drive (US 85) will close at Sunland Park Drive for a short distance of approximately 300 feet. Crockett Street access to eastbound Paisano Drive (US 85) will be open. Access will also be available via a right-turn-only lane from northbound Sunland Park Drive.
- All vehicles exiting at Sunland Park (exit 13) from I-10 will have to turn right on Sunland Park Drive or left onto the U-turn turnaround bridge. No vehicles will be allowed to go straight through the signalized intersection at Sunland Park Drive. Follow the detour signs.
- US 85 East will close at all access points from Sunland Park Drive.
- Paisano Drive (US 85) frontage road – in front of the auto dealerships – will close partially, preventing access to Racetrack Drive. Crockett Street access to Paisano Drive (US 85) will be open. The Paisano Drive entrance ramp to I-10 East be open.

[Map 1]

I-10 East at Mesa

Overnight

Monday, July 8

9 p.m. to 6 a.m. the next morning

- I-10 East will be reduced to one lane between the North Mesa overpass and the Executive Center overpass.



1 of 4

The Texas Department of Transportation is responsible for maintaining 80,000 miles of road and for supporting aviation, rail, and public transportation across the state. GO 10 is a \$158 million reconstruction of Interstate 10 that spans approximately 6 miles on El Paso's West Side between Executive Center Boulevard and North Mesa Street. GO 10 features the addition of collector-distributor lanes and a new direct connector with Border West Expressway.

Maintain a Safe System • Address Congestion • Best-in-Class State Agency • Connect Texas Communities

An Equal Opportunity Employer

www.go10elpaso.com | facebook.com/go10elpaso | twitter.com/go10ep



NEWS RELEASE

EL PASO DISTRICT

Jennifer Wright

(915) 790-4340

Jennifer.Wright3@txdot.gov

a TxDOT Project

For immediate release

- The North Mesa entrance ramp to I-10 East will close.

[No Map]

North Mesa

Nightly

Monday, July 8 and Tuesday, July 9

9 p.m. each night to 6 a.m. each morning

- North Mesa Street (SH 20) will close completely in both directions at the I-10 overpass. Detour: Motorists who wish to travel along North Mesa Street (SH 20) under the I-10 overpass should follow the detour signs.
- Both turnaround lanes at the I-10/ North Mesa Street interchange will close.
- North Desert Boulevard will close.
- All motorists exiting I-10 at North Mesa (exit 11) will be forced to turn right onto North Mesa Street (SH 20). No exiting vehicles will be allowed to pass straight through the signalized intersection at North Mesa Street (SH 20).

[Map 2]

I-10 West at Executive

Overnight

Tuesday, July 9

9 p.m. to 6 a.m. the next morning

- I-10 West will be reduced to one lane between the Executive Center overpass and the North Mesa overpass.
- The Sunland Park exit ramp from the main lanes of I-10 West will close.
- The Sunland Park entrance ramp to the main lanes of I-10 West will close.

[No Map]

Sunland Park

Daytime

Tuesday, July 9 and Wednesday, July 10

9 a.m. to 4 p.m. each day

- Sunland Park Drive – in the direction traveling northbound, toward the mountain – will have two right lanes closed between Machuca Drive and Paisano Drive (US 85). One through-lane will be open. The right turn lane onto Paisano will be closed.



2 of 4

The Texas Department of Transportation is responsible for maintaining 80,000 miles of road and for supporting aviation, rail, and public transportation across the state. GO 10 is a \$158 million reconstruction of Interstate 10 that spans approximately 6 miles on El Paso's West Side between Executive Center Boulevard and North Mesa Street. GO 10 features the addition of collector-distributor lanes and a new direct connector with Border West Expressway.

Maintain a Safe System • Address Congestion • Best-in-Class State Agency • Connect Texas Communities

An Equal Opportunity Employer

www.go10elpaso.com | facebook.com/go10elpaso | twitter.com/go10ep



NEWS RELEASE

EL PASO DISTRICT

Jennifer Wright

(915) 790-4340

Jennifer.Wright3@txdot.gov

a TxDOT Project

For immediate release

- Paisano Drive (US 85) – in front of the auto dealerships – will close completely at Sunland Park Drive. From Sunland Park Drive, access to Paisano Drive (US 85) will be available via Constitution Drive and Crockett Street.
- The westbound-to-eastbound turnaround bridge at the Sunland Park Drive overpass will close.

[Map 3]

Sunland Park

Overnight

Tuesday, July 9

9 p.m. to 6 a.m.

- Sunland Park Drive – in the direction traveling southbound, toward the railroad tracks – will close completely between the mall signalized intersection and Paisano Drive. Detour: Motorists should follow the detour signs.
- Vehicles exiting at Sunland Park (exit 13) from the eastbound CD lanes will be forced to turn right on Sunland Park Drive or turn left on the turnaround bridge. No vehicles will be allowed to go straight through the signalized intersection at Sunland Park Drive.
- Vehicles exiting at Sunland Park (exit 13) from I-10 West will be forced to turn right on Sunland Park Drive. No vehicles will be allowed to go straight through the signalized intersection at Sunland Park Drive.
- US 85 East will close at all access points from Sunland Park Drive.
- Paisano Drive (US 85) frontage road – in front of the auto dealerships – will close partially, preventing access to Racetrack Drive. Crockett Street access to Paisano Drive (US 85) will be open. The Paisano Drive entrance ramp to I-10 East be open.

[Map 4]

North Desert

Nightly

Wednesday, July 10 and Thursday, July 11

9 p.m. each night to 6 a.m. each morning

- North Desert Boulevard will close between North Mesa Street (SH 20) and Thorn Avenue. Detour: Motorists should use an alternate entrance ramp, such as the Redd Road entrance ramp.
- The North Mesa entrance ramp to the main lanes of I-10 West will close.
- The eastbound-to-westbound turnaround lane at the I-10/North Mesa interchange will close.



3 of 4

The Texas Department of Transportation is responsible for maintaining 80,000 miles of road and for supporting aviation, rail, and public transportation across the state. GO 10 is a \$158 million reconstruction of Interstate 10 that spans approximately 6 miles on El Paso's West Side between Executive Center Boulevard and North Mesa Street. GO 10 features the addition of collector-distributor lanes and a new direct connector with Border West Expressway.

Maintain a Safe System • Address Congestion • Best-in-Class State Agency • Connect Texas Communities

An Equal Opportunity Employer

www.go10elpaso.com | facebook.com/go10elpaso | twitter.com/go10ep



NEWS RELEASE

EL PASO DISTRICT

Jennifer Wright

(915) 790-4340

Jennifer.Wright3@txdot.gov

a TxDOT Project

For immediate release

- The Sunland Park entrance ramp to the main lanes of I-10 West will close.
- The North Mesa entrance ramp to the main lanes of I-10 East will close.

[Map 5]

I-10 East at Mesa

Overnight

Wednesday, July 10

9 p.m. to 6 a.m. the next morning

- I-10 East will be reduced to one lane between the North Mesa overpass and the Executive Center overpass.
- The North Mesa entrance ramp to I-10 East will close.

[No Map]

I-10 West at Executive

Overnight

Thursday, July 11

9 p.m. to 6 a.m. the next morning

- I-10 West will be reduced to one lane between the Executive Center overpass and the North Mesa overpass.
- The Sunland Park exit ramp from the main lanes of I-10 West will close.
- The Sunland Park entrance ramp to the main lanes of I-10 East will close.

[No Map]

All closures are subject to change or cancellation.

All closure times are approximate.

Exit and entrance ramps may close up to one hour prior to the start time of an I-10 closure.

page 4 of 4



The Texas Department of Transportation is responsible for maintaining 80,000 miles of road and for supporting aviation, rail, and public transportation across the state. GO 10 is a \$158 million reconstruction of Interstate 10 that spans approximately 6 miles on El Paso's West Side between Executive Center Boulevard and North Mesa Street. GO 10 features the addition of collector-distributor lanes and a new direct connector with Border West Expressway.

Maintain a Safe System • Address Congestion • Best-in-Class State Agency • Connect Texas Communities

An Equal Opportunity Employer

www.go10elpaso.com | facebook.com/go10elpaso | twitter.com/go10ep

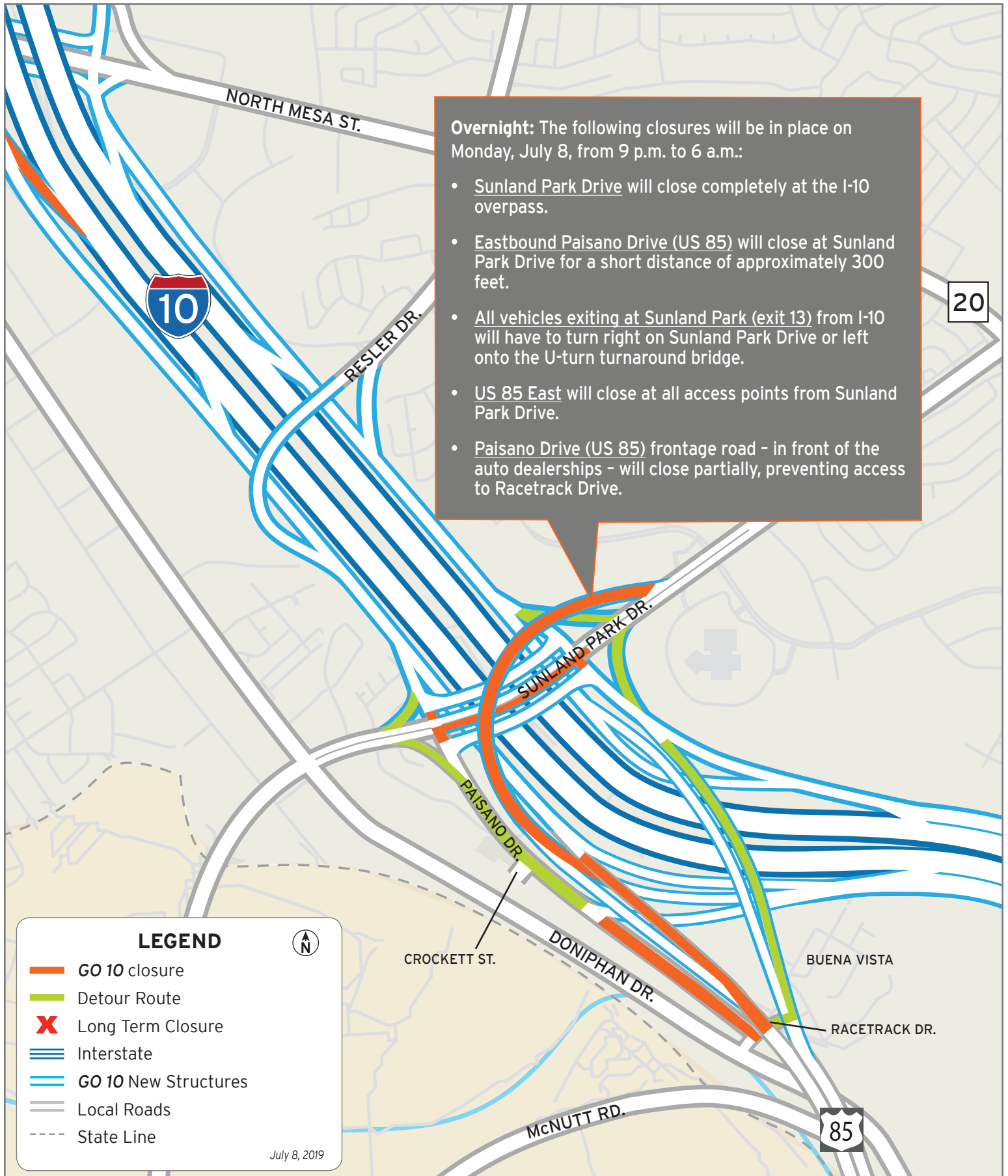

Closures on Sunland Park

Map 1 of 5



Nightly: The following closures will be in place July 8 and 9 from 9 p.m. each night to 6 a.m. each morning:

- North Mesa Street (SH 20) will close completely in both directions at the I-10 overpass. Detour: Motorists who wish to travel on North Mesa Street (SH 20) and under the I-10 overpass should follow the detour signs instead.
- Both turnaround lanes at the I-10/ North Mesa Street interchange will close.
- All motorists exiting at North Mesa (exit 11) will be forced to turn right onto North Mesa Street (SH 20).
- North Desert Blvd. will close.

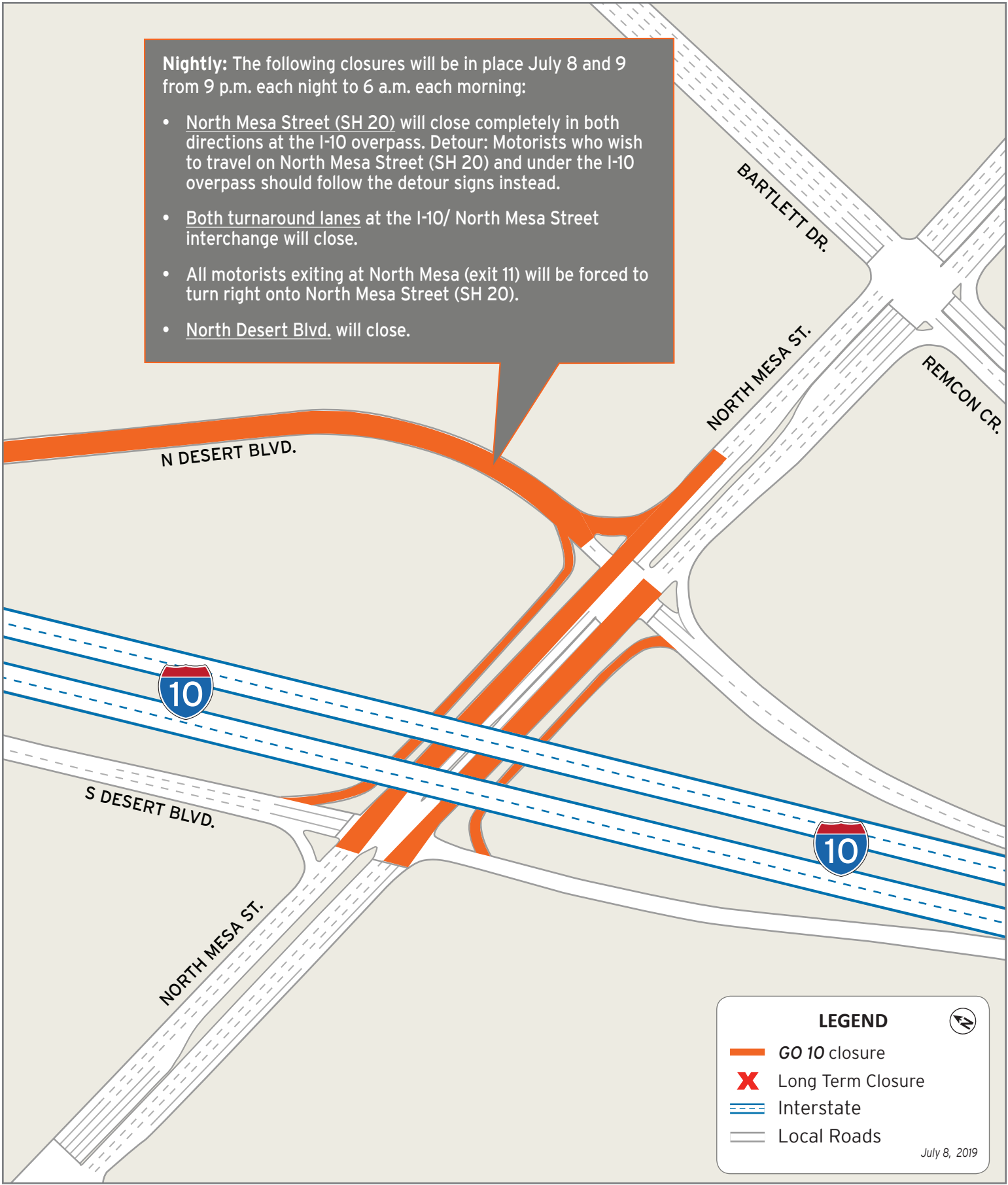

Closures at North Mesa Street

Map 2 of 5



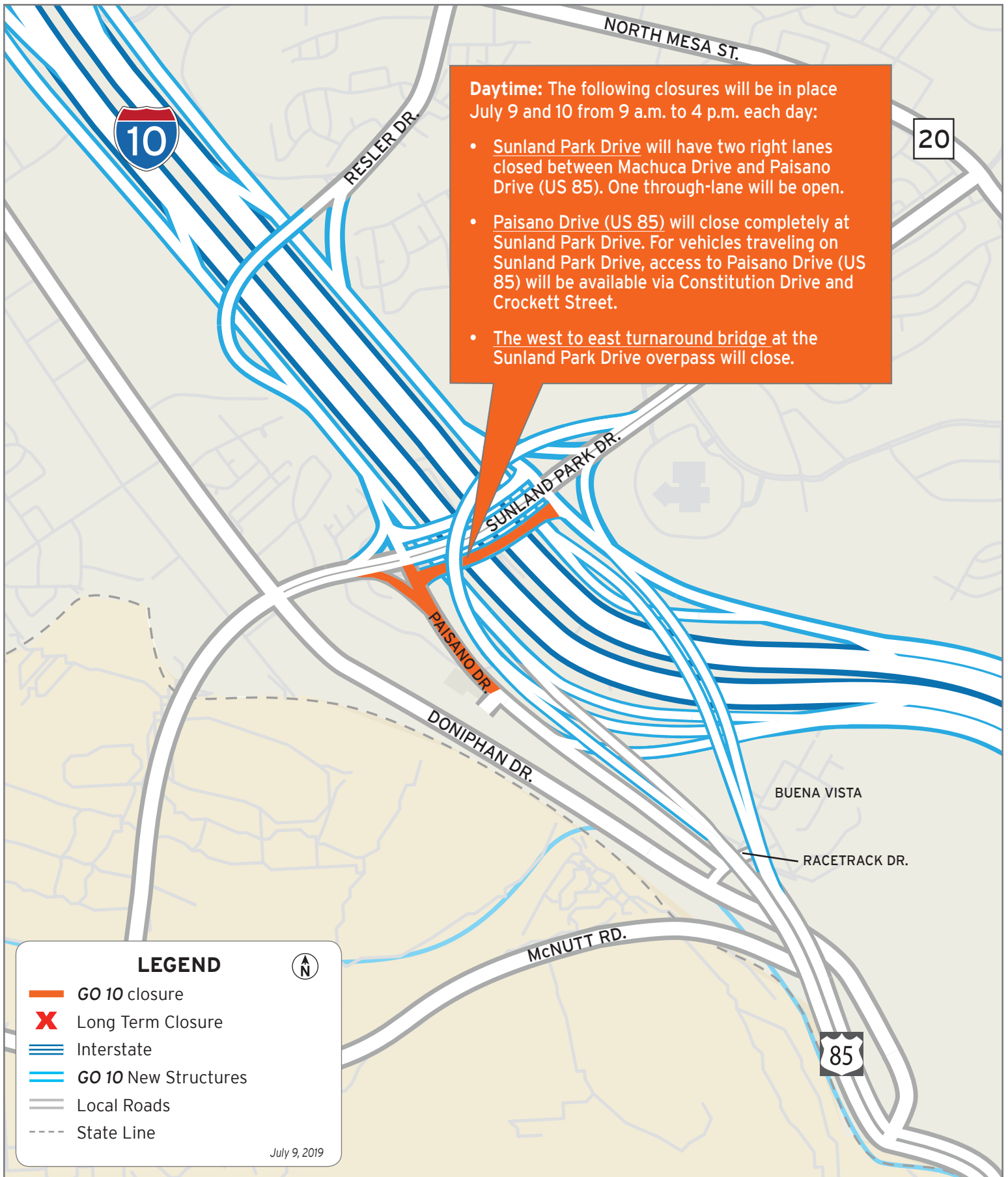

Closures on Sunland and Paisano

Map 3 of 5



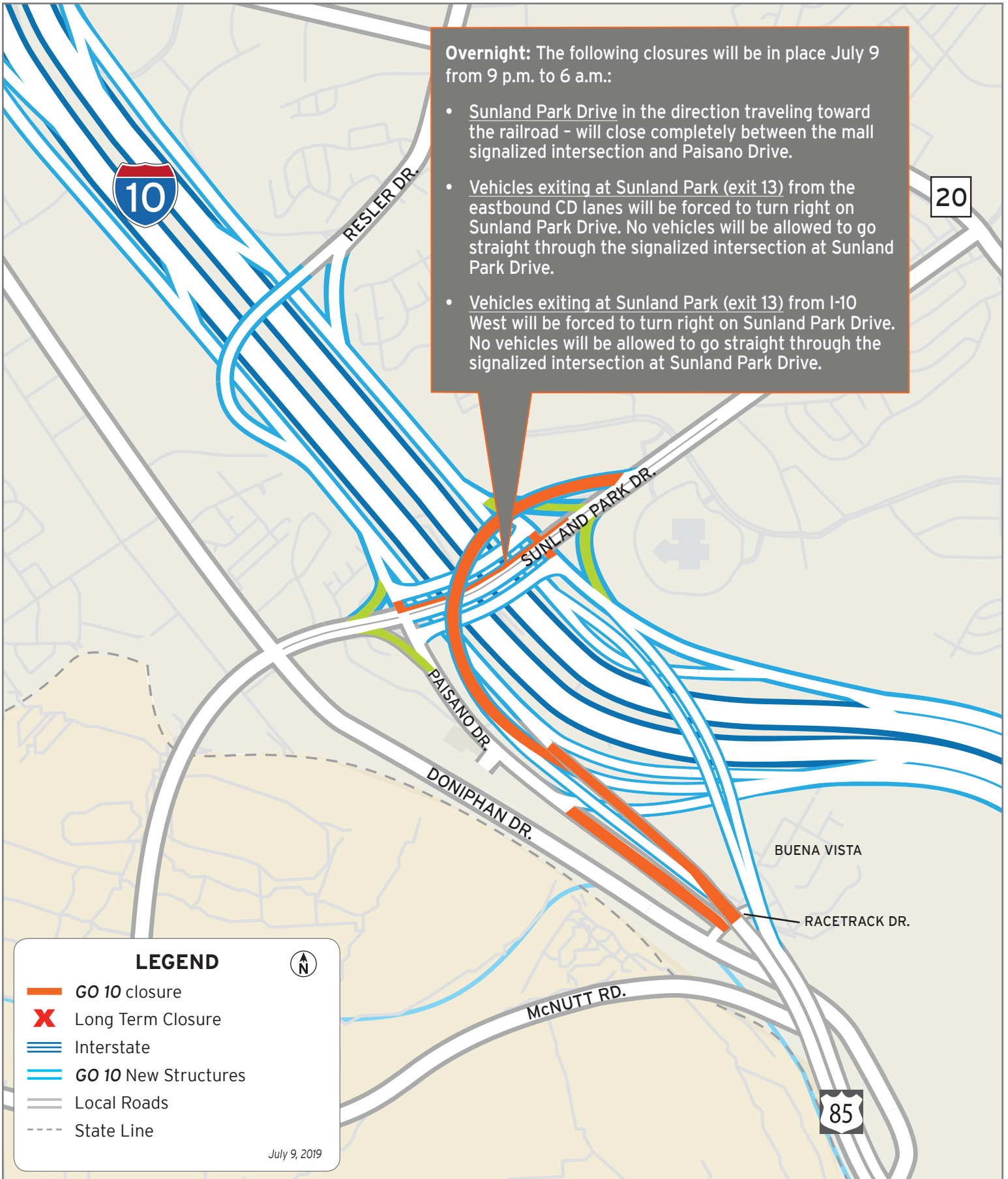

Sunland Park lanes to close

Map 4 of 5



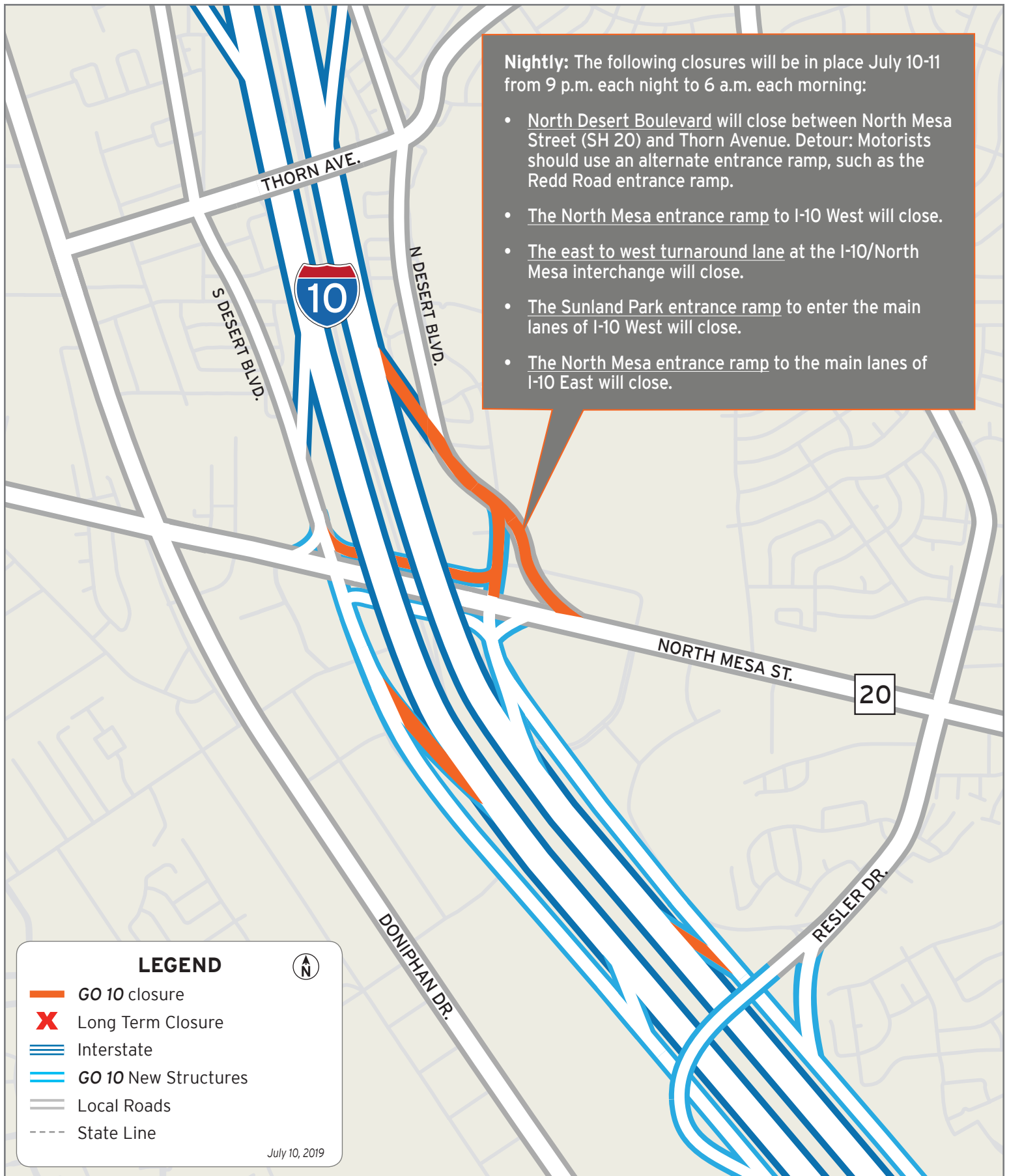

North Desert to close

Map 5 of 5

