



a TxDOT Project
For immediate release

NEWS RELEASE

EL PASO DISTRICT

Jennifer Wright
(915) 790-4340
Jennifer.Wright3@txdot.gov

April 21, 2017

Work at I-10 and Sunland continues.

Engineers plan to close I-10 for three nights in May.

I-10 & Sunland

Daytime

Monday, April 24 through Friday, April 28
9 a.m. to 4 p.m. each day

- The two-lane Sunland Park Exit Ramp (Exit 13, Westbound) will be reduced to one lane. This closure is necessary to give crews access to the work site. [No Map]

Daytime

Monday, April 24 through Friday, April 28
9 a.m. to 4 p.m. each day

- The left lane on I-10 in both directions will close between Buena Vista and Sunland Park. Crews are constructing new US 85 bridge columns in the area. Thank you for your patience. [See Map]

Daytime

Monday, April 24 through Wednesday, April 26
9 a.m. to 4 p.m. each day

- The left turn lane from the I-10 Westbound Sunland Park Exit Ramp onto Sunland Park Drive will close. Crews will be installing a traffic camera in the area. [See Map]

Overnight

Tuesday, April 25
9 p.m. to 6 a.m. the next morning

- I-10 Westbound will be reduced to one lane between Buena Vista and the Sunland Park Entrance Ramp to I-10 Westbound. Crews are re-setting barrier walls. [No Map]

page 1 of 2



The Texas Department of Transportation is responsible for maintaining 80,000 miles of road and for supporting aviation, rail, and public transportation across the state. GO 10 is a \$158 million reconstruction of Interstate 10 that spans approximately 6 miles on El Paso's West Side between Executive Center Boulevard and North Mesa Street. GO 10 features the addition of collector-distributor lanes and a new direct connector with Border West Expressway.

Maintain a Safe System • Address Congestion • Best-in-Class State Agency • Connect Texas Communities
An Equal Opportunity Employer

www.go10elpaso.com | facebook.com/go10elpaso | twitter.com/go10ep



a TxDOT Project
For immediate release

NEWS RELEASE

EL PASO DISTRICT

Jennifer Wright
(915) 790-4340
Jennifer.Wright3@txdot.gov

GO 10 WILL CLOSE I-10 NEXT MONTH

I-10 & Resler

Overnight

Tuesday, May 9

9 p.m. to 6 a.m. the next morning

- I-10 Westbound will close completely between Resler Drive (Exit 12) and North Mesa Street (Exit 11).

Crews will be pouring bridge deck onto the new Resler Flyover Ramp. [No Map]

Detour: Traffic on I-10 West will exit at Resler Drive (Exit 12), take Resler Drive to North Mesa Street (SH 20), and take North Mesa Street to I-10 Westbound.

Overnight

Wednesday, May 10 and Thursday, May 11

9 p.m. each night to 6 a.m. each morning

- I-10 in both directions will close completely at Resler Drive (Exit 12).

Crews will be pouring bridge deck onto the new Resler Flyover Ramp. [No Map]

Detour: Vehicles traveling on I-10 West will exit at Resler Drive (Exit 12), take Resler Drive to North Mesa Street (SH 20), and take North Mesa Street to I-10.

Vehicles traveling on I-10 East will exit at North Mesa Street (Exit 11), take North Mesa Street (SH 20) to Doniphan Drive (SH 20), take Doniphan Drive to Sunland Park Drive, and take Sunland Park Drive to I-10.

All closure start times and end times are approximate.

All closures are subject to change.

The latest information may be found on the traffic alerts page at go10elpaso.com.

page 2 of 2



The Texas Department of Transportation is responsible for maintaining 80,000 miles of road and for supporting aviation, rail, and public transportation across the state. GO 10 is a \$158 million reconstruction of Interstate 10 that spans approximately 6 miles on El Paso's West Side between Executive Center Boulevard and North Mesa Street. GO 10 features the addition of collector-distributor lanes and a new direct connector with Border West Expressway.

Maintain a Safe System • Address Congestion • Best-in-Class State Agency • Connect Texas Communities

An Equal Opportunity Employer

www.go10elpaso.com | facebook.com/go10elpaso | twitter.com/go10ep

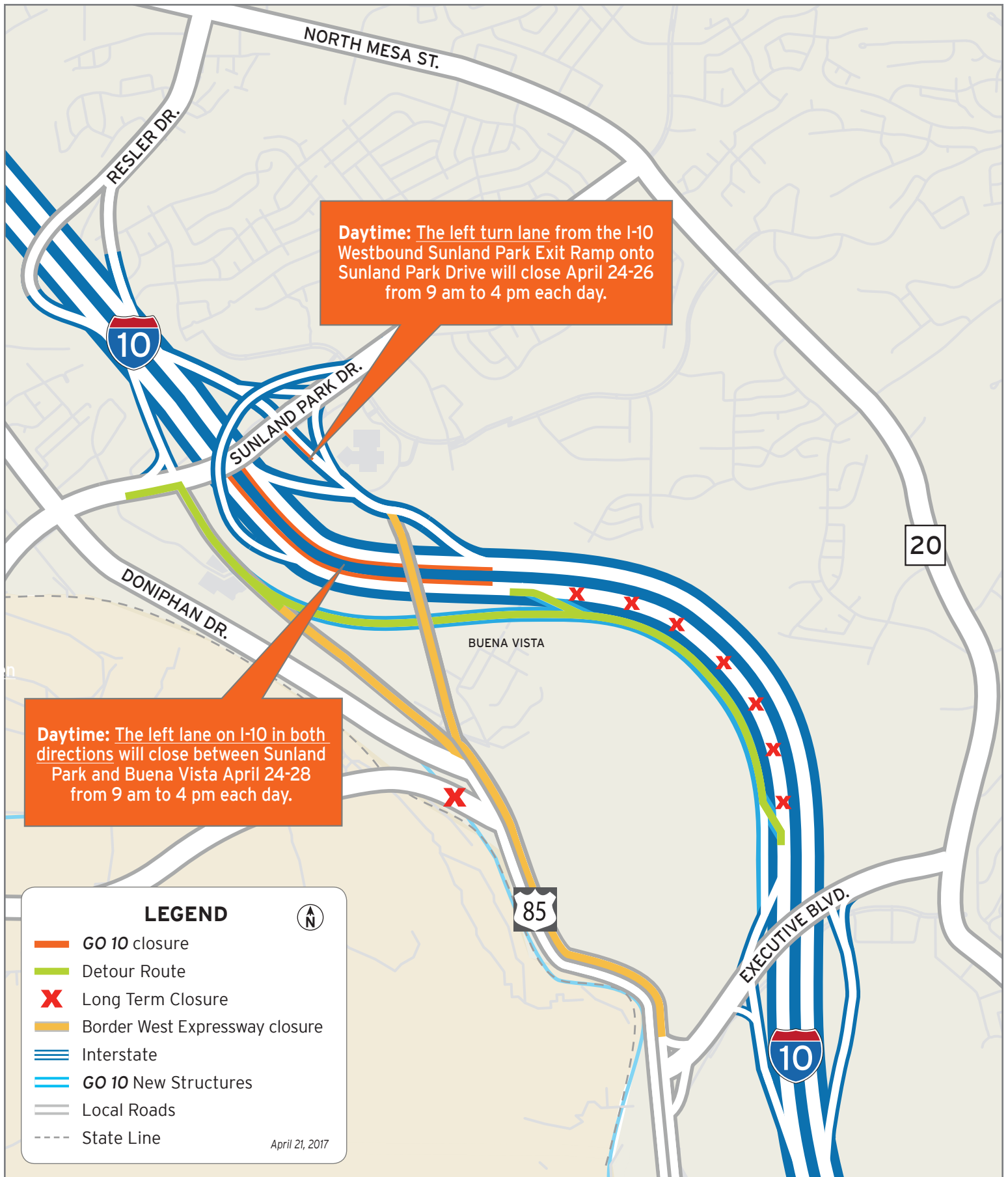

Daytime closures on I-10 at Sunland

